

- 1- FOR SYMBOLS & ABBREVIATIONS SEE DETAIL SHEETS.
- 2- EXISTING & NEW WATER MAIN INCLUDING FIRE HYDRANT LOCATIONS ARE SHOWN ON STRUCTURAL ENGINEERS DRAWINGS BY MAIN CONTRACTOR.
- 3- CONNECTION TO THE EXISTING WATER MAIN WATER &/OR GAS MAIN SHALL BE MADE BY OTHERS. THE MAIN CONTRACTOR SHALL BE RESPONSIBLE FOR MAKING A CONNECTION TO SAME.
- 4- THURST BLOCK SHALL BE PROVIDED BY THE MAIN CONTRACTOR AT EVERY CHANGE OF DIRECTION OR LEVEL OF EXISTING M.V.S. PIPEWORK.
- 5- UNDERGROUND MAINS WATER PIPEWORK SHALL HAVE A MINIMUM COVER OF 1000mm & GREATER THAN 1350mm.
- 6- UNDERGROUND GAS PIPEWORK SHALL HAVE A MINIMUM COVER OF 1000mm & NOT GREATER THAN 1350mm.
- 7- UNDERGROUND DIESEL PIPEWORK SHALL HAVE A MINIMUM COVER OF 750mm & NOT GREATER THAN 1350mm. PIPEWORK TO BE SHARPENED WITH CUNIP.
- 8- THE CONTRACTOR SHALL ENSURE THAT ADEQUATE PROVISIONS ARE MADE ON THE MAIN TO FACILITATE FULCRUM & SWABING & SHOULD BE CHECKED WITH THE LOCAL AUTHORITY PRIOR TO THE INSTALLATION OF THE MAIN.
- 9- WHERE DEPTH OF COVER OF WATER MAIN IS NOT SUFFICIENT, PIPE IS TO BE ENCASED IN 500mm OF CONCRETE.
- 10- FOR SCHEDULES OF EQUIPMENT SEE SPECIFICATION.
- 11- THE COMPLETE INSTALLATION TO BE CO-ORDINATED WITH ALL OTHER SERVICES.

12. DUCTING SHALL COMPLY WITH ENDS 50086-1.2-3.4 LATEST EDITION & SHALL BE SINGLE WALL, COLOURED RED & MANUFACTURED FROM HIGH DENSITY POLYETHYLENE. THE NOMINAL EXTERNAL DIAMETER OF THE DUCT SHALL BE 107mm WITH A MINIMAL WALL THICKNESS OF 3.0mm. EACH LENGTH OF DUCT SHALL BE SUPPLIED WITH THE ABOVE "90 DEGREE ELBOW" OR "STRAIGHT THROUGH" STREET LIGHTING". IN 18mm DIA. C/L LETTERING AT 90 DEGREES, AT TWO METRE INTERVALS. DUCT SHALL BE LAID WITH THIS LEGEND FACING UPWARDS. DUCT SHALL BE LAID IN A STRAIGHT LINE CLOSE TO THE LINE OF THE COLUMN LOCATIONS & SHALL CONTAIN A CONTINUOUS DRAW WIRE OF 8K STRENGTH.

13. A MINIMUM DEPTH OF 450mm COVER IS REQUIRED IN URBAN PATHWAYS & A MINIMUM OF 600mm COVER IS REQUIRED FOR GRASS MARGINS, PEDESTRIAN WAYS, LANEWAYS & GATEWAY AREAS. A MINIMUM DEPTH OF 750mm IS REQUIRED AT ROAD CROSSINGS OR IN CARRIAGEWAYS.

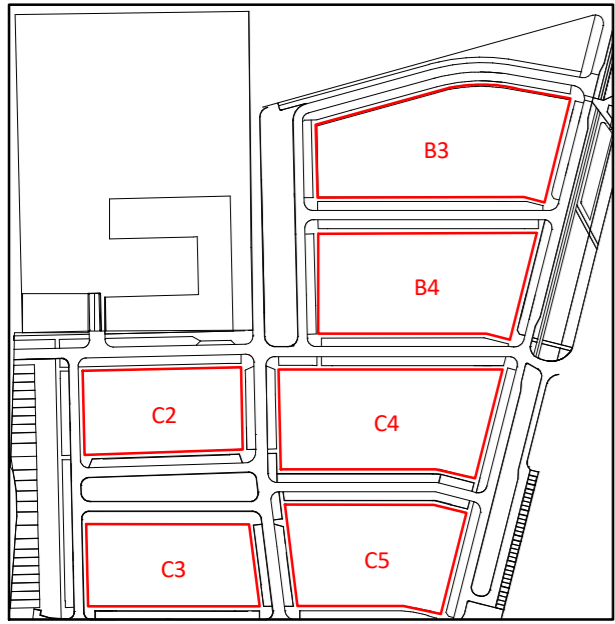

BALDOYLE GA01
KEY PLAN
SCALE N.T.S.

EX MWYS	EXISTING MAINS WATER
EIR	2Nos. 100mm ² EIR DUCT
VIR	2Nos. 100mm ² VIRBON DUCT
MV	6Nos. 160mm ² MV DUCT
ESB	4Nos. 125mm ² ESB DUCT
EX ESB	EXISTING ESB DUCT (TO BE RELOCATED)
EVC	2Nos. 125mm ² DUCTS FOR FUTURE EVC STATIONS
	MINI PILLAR (LOCATION & DETAIL TO BE AGREED WITH ESB & ARCHITECT)
	ESB RISER (LOCATION & DETAIL TO BE AGREED WITH ESB & ARCHITECT)
	ESB SUB-STATION (LOCATION & DETAIL TO BE AGREED WITH ESB & ARCHITECT)
	ELECTRIC VEHICLE CHARGER MINI PILLAR (LOCATION & DETAIL TO BE AGREED WITH ESB & ARCHITECT)
	PUBLIC LIGHTING MINI PILLAR
	450x4500mm DUCT
	COLUMN MOUNTED FLOOD LIGHT
	ELECTRIC VEHICLE CHARGER SINGLE OUTLET CHARGER
	CAR PARKING SPACE WITH CAR CHARGER

NOTE:
ESB DUCT ROUTES AS PER ESB
RECOMMENDED LAYOUTS.
EIR AND VIRGIN MEDIA DUCT ROUTES ARE
INDICATIVE ONLY.
AWAITING CONFIRMATION FROM BOTH
UTILITIE PROVIDERS AS TO THEIR
PROPOSED DUCT ROUTES.

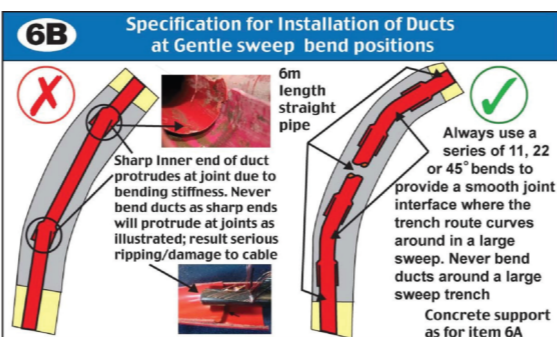

DETAIL No.1
ESB STANDARD DUCTING DETAIL
SCALE N.T.S.

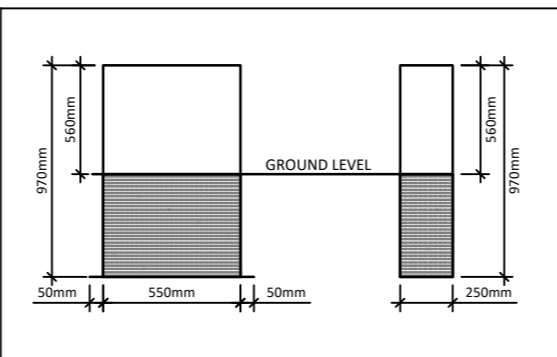

DETAIL No.3
ESB STANDARD MINIPILLAR DETAILS
SCALE N.T.S.

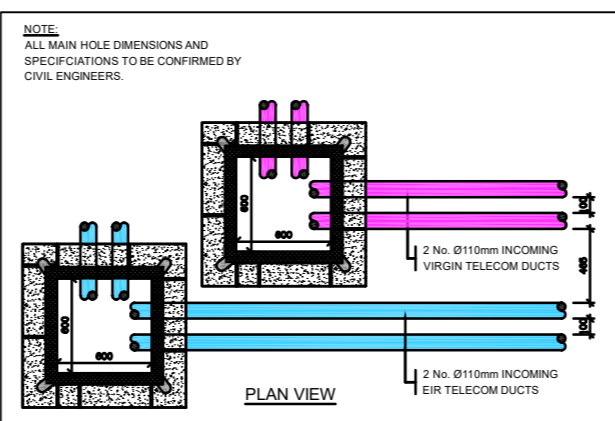

DETAIL No.10
TYPICAL DETAIL OF INCOMING TELECOM PROVIDER
TYPE 'A' MANHOLES LAYOUT
SCALE: N.T.S.

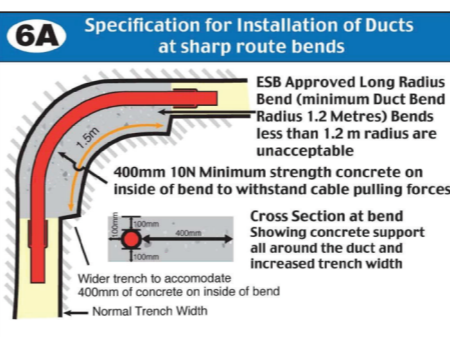

DETAIL No.2
ESB STANDARD DUCTING DETAIL
SCALE N.T.S.

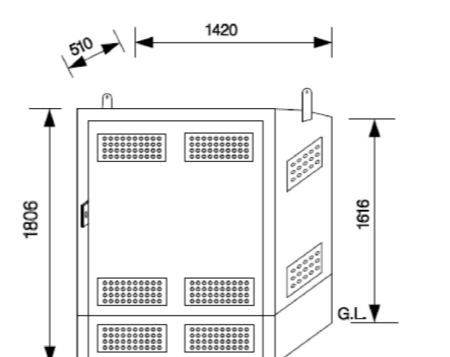

DETAIL No.4
DRI PRESSURE REDUCING STATION
SCALE 1/8"

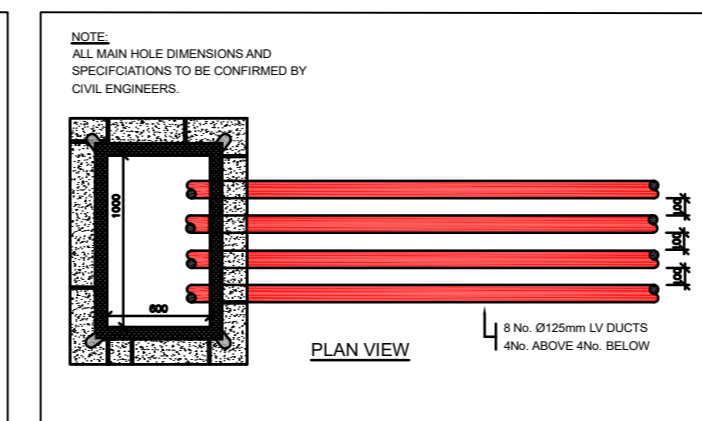

DETAIL No.9
TYPICAL DETAIL OF LV MANHOLE LAYOUT
SCALE N.T.S.

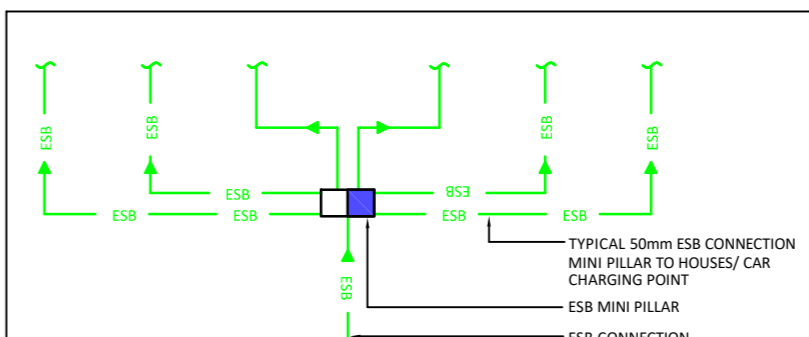

DETAIL No.5
TYPICAL ESB MINIMUM CONNECTION DETAIL

No. Of Ducts in Row	1	2	3	4	5	6
Minimum Trench Width	325	525	875	1150	1425	1700

DETAIL No.6
ESB STANDARD TRENCH DETAILS
SCALE N.T.S.

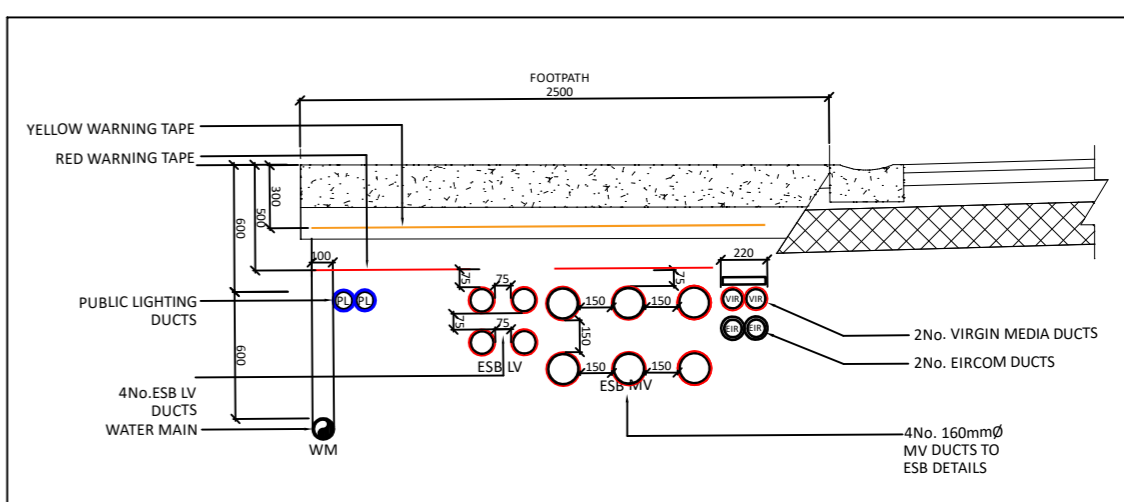

DETAIL No. 8
A-A TYPICAL TRENCH DETAIL
SCALE: N.T.S.

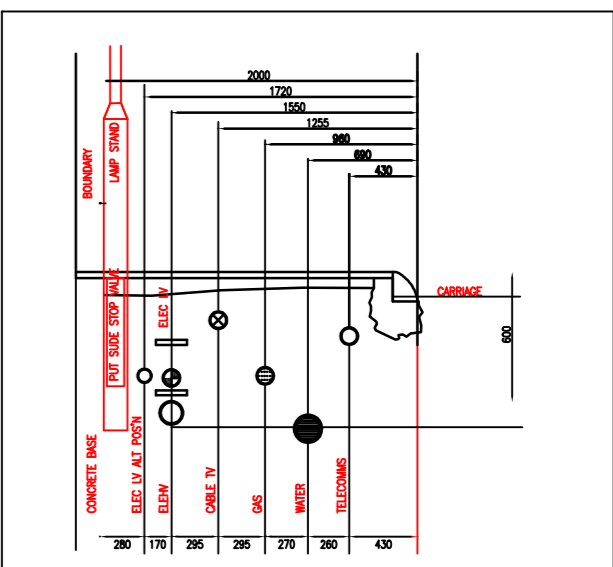

DETAIL No.7
TYPICAL POSITIONING OF UTILITY SERVICES UNDER FOOTWAY
SCALE N.T.S.

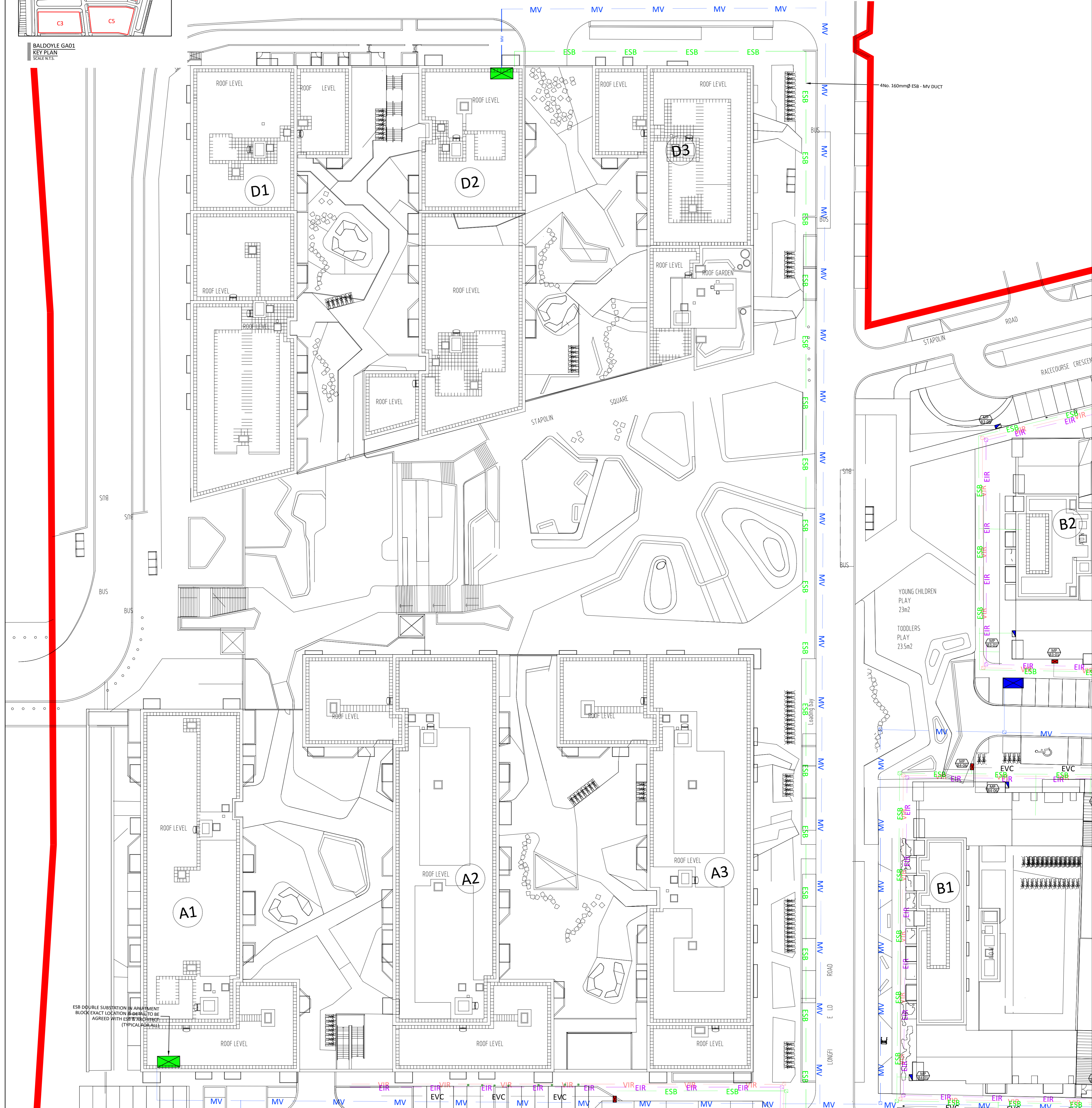

- FOR SETTING OUT REFER TO ARCHITECT'S DRAWINGS.
- THIS DRAWING TO BE READ IN CONJUNCTION WITH ALL OTHER ARCHITECTURAL AND ENGINEERING DRAWINGS AND ALL OTHER RELEVANT DRAWINGS AND SPECIFICATIONS.
- DO NOT SCALE THIS DRAWING. USE FIGURED DIMENSIONS ONLY.
- NO PART OF THIS DOCUMENT MAY BE REPRODUCED OR TRANSMITTED IN ANY FORM OR STORED IN ANY RETRIEVAL SYSTEM OF ANY NATURE WITHOUT THE WRITTEN PERMISSION OF O'CONNOR SUTTON CRONIN AS COPYRIGHT HOLDER EXCEPT AS AGREED FOR USE ON THE PROJECT FOR WHICH THE DOCUMENT WAS ORIGINALLY ISSUED.

Rev No.	Date	Revision Note	Drn by	Chkd by
P01	29.05.20	ISSUED FOR COMMENT.	I.F.	J.D.
P02	09.10.20	ISSUED FOR COMMENT.	I.F.	B.R.
P03	11.05.21	ISSUED FOR PLANNING.	B.M.	B.R.

Rev No.	Date	Revision Note	Drn by	Chkd by

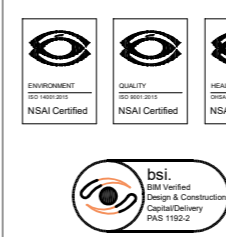

Head Office,
9 Prussia Street,
Dublin 7.
D07 KT57

TEI +353 (0)1 8682000

e: contactus@ocsc.ie
w: www.ocsc.ie



Client:	THE SHORELINE PARTNERSHIP
Project:	BALDOYLE STAPOLIN GROWTH AREA -1
Title:	MECHANICAL & ELECTRICAL SITE SERVICES LAYOUT

Code	Originator	Zone	Level	Type	Role	Number	Status	Revision
R500	OCSC	GA01	XX	DR	ME	0004	S4	P03